

## C23 series circular locomotive connector



## Part number

	C23	P	5	P <sub>1</sub>
Basic series				
Type of connector				
P = Plug				
R = Receptacle				
Contact number				
See below				
Plating				
P <sub>1</sub> = Electroless nickel plating with blast sand				

## Electrical performance

Contact resistance:  $\leq 2.5 \text{ m}\Omega$

Rated current: 13 A

Rated operating voltage: 500 V

Withstanding voltage: 3250 V

Insulation resistance:  $\geq 5000 \text{ M}\Omega$  (Normal),  $\geq 500 \text{ M}\Omega$  (Damp and heat)

## Mechanical performance

Endurance: 750 cycles

Insertion and withdrawal force of contact: 0.45N ~ 1.2N

Cross section of conductor:  $0.5 \text{ mm}^2 \sim 1.25 \text{ mm}^2$

## Environmental performance

Operating temperature:  $-40 \text{ }^\circ\text{C} \sim +100 \text{ }^\circ\text{C}$

Humidity: 92% ~ 95% (40  $^\circ\text{C}$ )

Vibration: 1 ~ 10 Hz, amplitude 7.5 mm; 10 ~ 55 Hz, amplitude 0.6 mm; 55 ~ 500 Hz, 60 m/s<sup>2</sup>

## Material

Shell: Copper-alloy

Contact: Copper-alloy

Finish of shell: Electroless nickel plating with blast sand

Finish of contact: Gold plating

## Contact layout

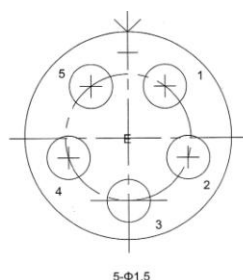

# Size

Plug (C23-P5-P<sub>1</sub>)

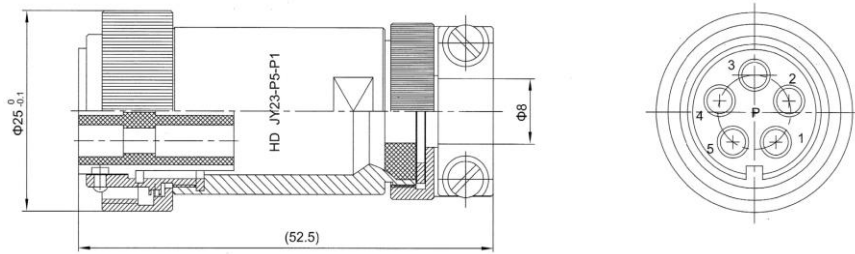

Receptacle (C23-R5-P<sub>1</sub>)

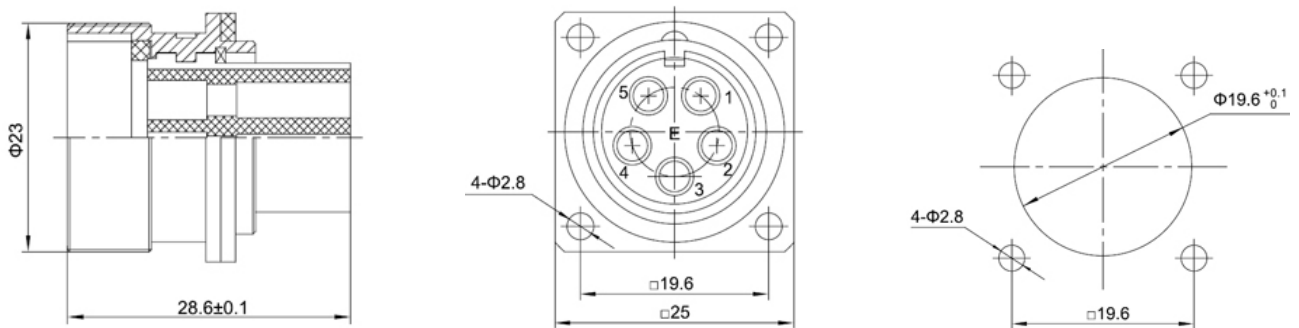

Contact (C23-1.5P)

